

## LCA 30

The Leyro LCA 30 multifunction temperature calibrator is an equipment suitable for all conditions and applications, covering different kind of industries. The Leyro LCA 30 multifunction is the most advanced equipment in its class. Designed to work in a few minutes, as a dry block and as a liquid bath. Thanks to the wide variety of inserts available, it allows you to calibrate any probe or thermocouple. The LCA 30 device has a temperature range of -35°C ... 165°C \*, stability of 0.01°C and accuracy of 0.1°C.



### APPLICATIONS

Calibration Laboratories  
Testing Labs  
Universities / R & D  
Chemical / Pharmaceutical Industry  
Food industry  
Maintenance and Service

### HIGHLIGHTS

Fast Response Time  
Temperature range -35 ... 165°C\*  
External Reference Temperature  
Immersion Depth: 190 mm  
Resolution: 0,1/0,01/ 0,001°C  
Stability: 0,01°C  
Accuracy: 0,1°C  
Uniformity: 0,05°C  
Portable  
3 Years Warranty

### General Information

User interface with a touch screen of 4,3 inches  
All in one equipment (Dry Block/Liquid Bath)  
Data Register in a 80 Mb internal memory  
Function of 40 programmes  
Trend Graph  
Ethernet communication and two USB ports  
Barcode reader  
External Reference PT 100 4 Wires probe



### Technical Data

Operating Temperature Range(°C)	-35...165°C*
Accuracy	0,1°C
Resolution	0.1/ 0,01/ 0,001°C
Temperature Control	Internal/ External PT100 (3/4 Wires)
Calibration Volume	Ø 60mm x 190 mm
Warm-Up time	From -5 to 100°C   25 Minutes
Cooling time	From 25 to -25°C   45 Minutes
Housing and assembly	Portable
Dimensions W x L x H (cm)	280 x 370 x 440
Weight (kg)	15.2 kg
Supply	100 ... 234 Vac 50/60 Hz
Power Consumption	Approx 310 W

LIQUID BATH**		DRY BLOCK	
Temperature Stability	±0.01 °C	Temperature Stability	0,01 °C
Uniformity	±0.05 °C / 0,09 °F	Uniformity	0,05 °C
Accuracy	0,1°C / 02°F	Insert Dimensions	59,5mm x165mm
Well capacity	0.7 liters	Standar Insert	A. 1 x Ø 3,5 /1 x Ø 6,5/ 1 x Ø 8,5/ 1 x Ø 10,5
		Optional Inserts	
		B.	2 x Ø 3,5 /2x Ø 4,5/ 2 x Ø 6,5/ 2 x Ø 8,5/ 2 x Ø 10,5
		C.	3 x Ø 3,5 /3x Ø 6,5/ 3 x Ø 8,5/3 x Ø 10,5
		D.	2 x Ø 3,5 /1x Ø 4,5/ 1 x Ø 5,0/1 x Ø 5,5/1 x Ø 6,5/ 1 x Ø 8,5 /1x Ø 9,0/ 1 x Ø 9,5/1 x Ø 10,5
		E.	Blank

\*Minimum Temperature Range is 55 °C, below ambient. Absolute minimum -35°C

\*\*It is recommended to use 10 Cst silicone oil



A

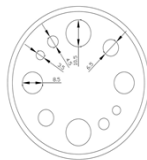

B

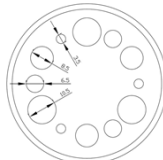

C

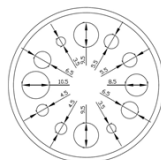

D

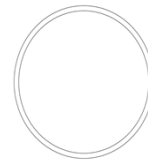

E

### Scope of delivery

Basic Instrument LCA 30  
Power Cord  
Teflon Magnetic Stirrer  
Manufacturing Traceable Calibration Certificate 8 Points  
Instruction Manual  
Drain Pump  
3 Years of Warranty against factory defects

### Options

Dry Block / Liquid Bath Function  
Trolley transport case with wheels and handle  
ENAC Calibration Certificate  
Methacrylate lid with 6 inserts  
External Control  
Pt 100/ 4 Wires  
Several types of inserts ( See the Dry Block Tecnical Data)

# Cal Power

Via Acquanera, 29  
tel. 031.526.566 (r.a.)  
info@calpower.it

22100 COMO  
fax 031.507.984  
www.caltower.it